



Finger Rake TR

PARTS LIST

General Information

Serial No. Prefix TR..... ..from serial no. 4691H
 Serial number is located on front RH side of frame.

Special Notes:

- | | | | |
|----|---------------------|----------|-------------------------|
| ◀ | Left Hand | Y | Alternative |
| ▶ | Right Hand | * | Change since last print |
| ▲ | Upper | 306357x6 | Quantity |
| ▼ | Lower | 306357# | Quantity as required |
| ◀▶ | Width | 11 | Only for |
| ▶▶ | Length | 11 | Central |
| T | From serial number | 11 | Offset |
| ↑ | Up to serial number | Z | Number of teeth |
| ↺ | rpm | | |

Catalogue no.	Issue	Page Affected
77097	5/90	New Issue

TR SERIES RAKE

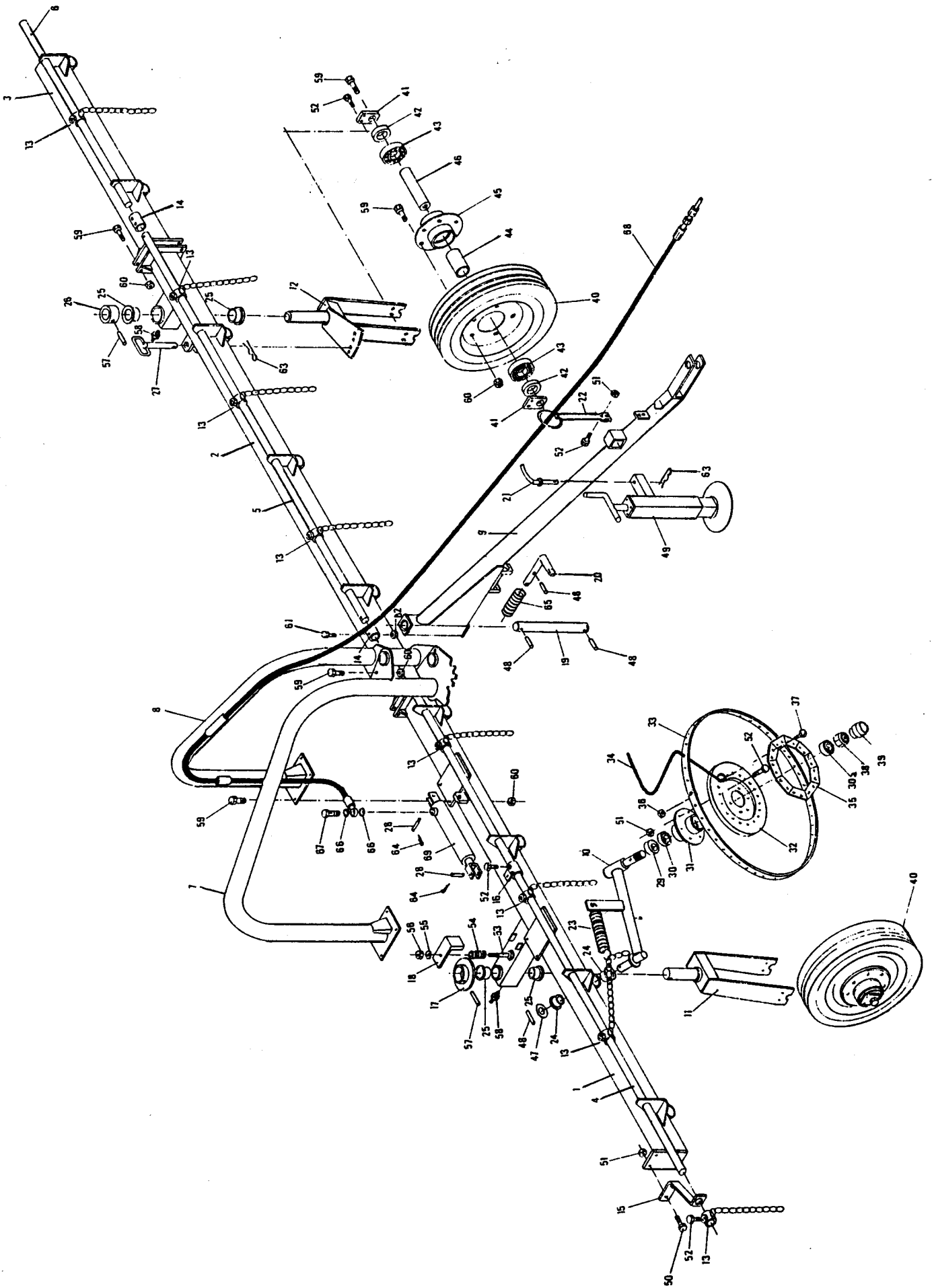

TR6, 7, 8, 9, PARTS LIST

ITEM	PART NO	DESCRIPTION	QTY	ITEM	PART NO	DESCRIPTION	QTY
1	FW101	Frame - front (TR6, TR8)	1	55	308160015	Flat washer	1
	FW101/A	" " (TR7, TR9)	1	56	307216015	Nut M16	1
2	FW102	Frame - rear	1	57	208089610	Pin 10 x 80	2
3	FW103	Frame - extension (TR8, TR9)	1	58	202030860	Grease nipple M8 x 1.25	2
4	FW104	Rod - Front, 2400 lg (TR6, TR8)	1	59	301116405	Setscrew M16 x 40 PLS	As req
	FW105	" " 2900 lg (TR7, TR9)	1	60	209679390	Locknut M16 PLS	As req
5	FW105	Rod - centre 2900 lg	1	61	301208505	Bolt M8 x 50	4
6	FW106	Rod - extension 1600 lg (TR8, TR9)	1	62	307208055	Locknut M8	4
7	FW107	Drawbar support - front	1	63	208014030	R Clip	2
8	FW108	" " rear	1	64	208010860	Split pin	4
9	FW109	Drawbar	1	65	FW165	Spring	1
10	FW110	Support - finger wheel	As req	66	FW166	Copper washer	2
11	FW111	Support - front wheel	1	67	FW167	Fitting	1
12	FW112	Support - Rear wheel	1	68	FW168	Hose	1
13	FW113	Chain	As req	69	FW169	Hydraulic cylinder	1
14	FW114	Joiner	As req	NI	FW169K	Seal Kit	-
15	FW115	Bracket S200.013	1				
16	FW116	Bracket	1				
17	FW117	Bush/collar	1				
18	FW118	Bush lock	1				
19	FW119	Pin - drawbar	1				
20	FW120	Pin - drawbar lock	1				
21	FW121	Pin - Park stand	1				
22	FW122	Support - hose	1				
23	FW123	Spring S200.046	As req				
24	FW124	Nylon bush	As req				
25	FW125	Brass bush	As req				
26	FW126	Collar	1				
27	FW127	Lockpin	1				
28	FW128	Lockpin	2				
29	FW001	Dust cover	As req				
30	252552156	Bearing	As req				
30a	252047151	Bearing	As req				
31	FW003	Hub ← FW034 ASSY	As req				
32	FW005	Flange	As req				
33	FW007	Rim	As req				
34	FW002	Tyne	As req	32-37	FW036	Wheel Assy	As req
35	FW004	Clamp plate	As req				
36	307210115	Nut M10 Conloc	As req				
37	FW035	Bolt - tyne fixing 321210255	As req				
38	307218055	Self lock nut M18 PLS	As req				
39	FW006	Cap	As req				
40	FW140/1	Rim	2				
	FW140/2	Tyre 6.00/6 S600.282	2		S600.281	Wheel Assy 15"	
	FW140/3	Tube	2				
41	FW141	Plate - axle fixing	4				
42	FW142	Spacer	4				
	FW143	Hub assy (Items 43 - 46)	2				
43	254080188	Bearing	4				
44	FW144	Spacer	2				
45	FW145	Hub	2				
46	FW146	Axle	2				
47	FW147	Washer	As req				
48	208089760	Pin 8 x 50	As req				
49	FW149	Park stand assy	1				
50	301210405	Bolt M10 x 40	2				
51	307210055	Locknut M10	As req				
52	301410255	Setscrew M10 x 25	As req				
53	301216805	Bolt M16 x 80	1				
54	FW154	Spring	1				